

- 1
- 2
- 3
- 4
- 5
- 6
- 7
- 8
- 9
- 10
- 11
- 12
- 13
- 14
- 15
- 16
- 17
- 18

**MATERIAL**

Zinc-plated steel.

**ELASTIC LAMINA**

AISI 301 stainless steel.

**FEATURES AND APPLICATIONS**

GN 506.2 dowels for T-slots with guide are suitable for use on aluminium sections. The elastic lamina, located outside the dowel, allows it to slide avoiding accidental vertical slipping.

These dowels are highly recommended for use with fixing hinges for aluminium sections type CFG. (see page 1514).



**Application example**

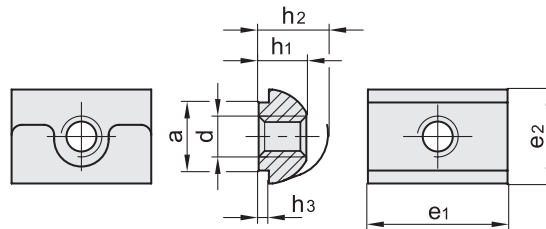
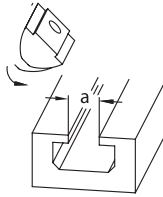

Conversion Table	
1 mm = 0.039 inch	
a	
mm	inch
8	0.31
10	0.39

**METRIC**

Code	Description	a	d	e1	e2	h1	h2	h3-0.1	Width a	$\Delta$
GN.24532	GN 506.2-8-M4	8±0.1	M4	16	11.5	5.8	8.5	1	8	6
GN.24533	GN 506.2-8-M5	8±0.1	M5	16	11.5	5.8	8.5	1	8	5
GN.24534	GN 506.2-8-M6	8±0.1	M6	16	11.5	5.8	8.5	1	8	5
GN.24535	GN 506.2-8-M8	8±0.1	M8	16	11.5	5.8	8.5	1	8	3
GN.24543	GN 506.2-10-M5	10 -0.1/-0.3	M5	20.5	13.8	5.2	10.2	1.5	10	9
GN.24544	GN 506.2-10-M6	10 -0.1/-0.3	M6	20.5	13.8	5.2	10.2	1.5	10	8
GN.24545	GN 506.2-10-M8	10 -0.1/-0.3	M8	20.5	13.8	5.2	10.2	1.5	10	7

Machine elements